

Motor Data						
Motor Codes	573P42-5206A	573P56-5606A	573P79-5806A			
1 Voltage/Phase	6.76	3.92	6.09			V
2 Current/Phase	5.2	5.6	5.8			A
3 Resistance/Phase	1.3	0.7	1.05			Ω
4 Inductance/Phase	1.1	1.1	1.3			mH
5 Holding Torque	45	90	150			N.cm
6 NO. Leads	6	6	6			
7 Rotor Inertia	100	300	480			gcm <sup>2</sup>
8 Length	42	56	79			mm
9 Weight	0.48	0.72	1.1			kg
General specifications						
10 Step angle						1.2°
11 Step Angle Accuracy						±5% (full step, no load)
12 Resistance Accuracy						±10%
13 Inductance Accuracy						±20%
14 Insulation Resistance						500VDC 100MΩMin
15 Dielectric Strength						500VAC 1 minute
16 Ambient Temperature						-20°C -- +50°C
17 Temperature Rise						80°C Max(rated current)
18 Shaft Axial Play						0.08mm Max(450g load)
19 Shaft Radial Play						0.02mm Max(450g load)
20 Max Axial Force						15N
21 Max Radial Force						75N(20mm from the flange)
22 Insulation Class						B

## Dimensional drawing

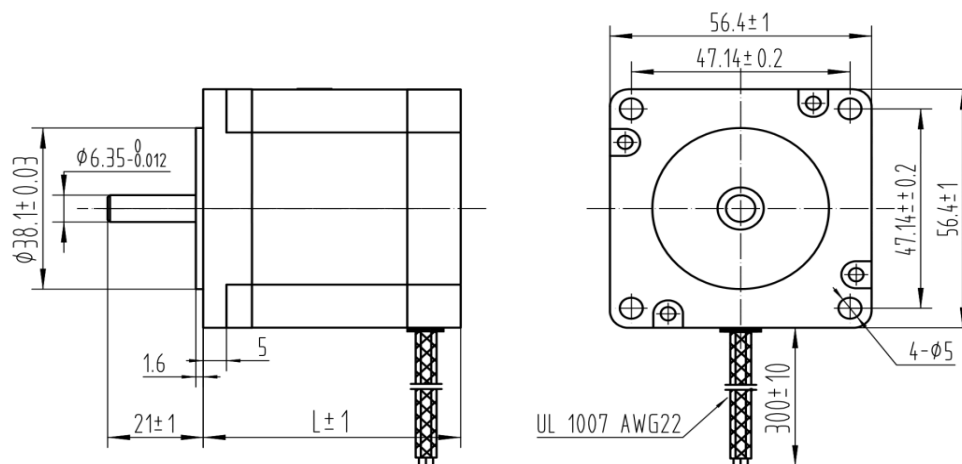

## Option, cable and connection information

### Connection Motor (UL1007 AWG22)

WHT	V
BLU	V
RED	U
ORG	U
GRN	W
YEL	W

